



V-RAY RENDERING COURSE

WWW.ELEGANT-TRAINING.AE



f 1920 x 1080]

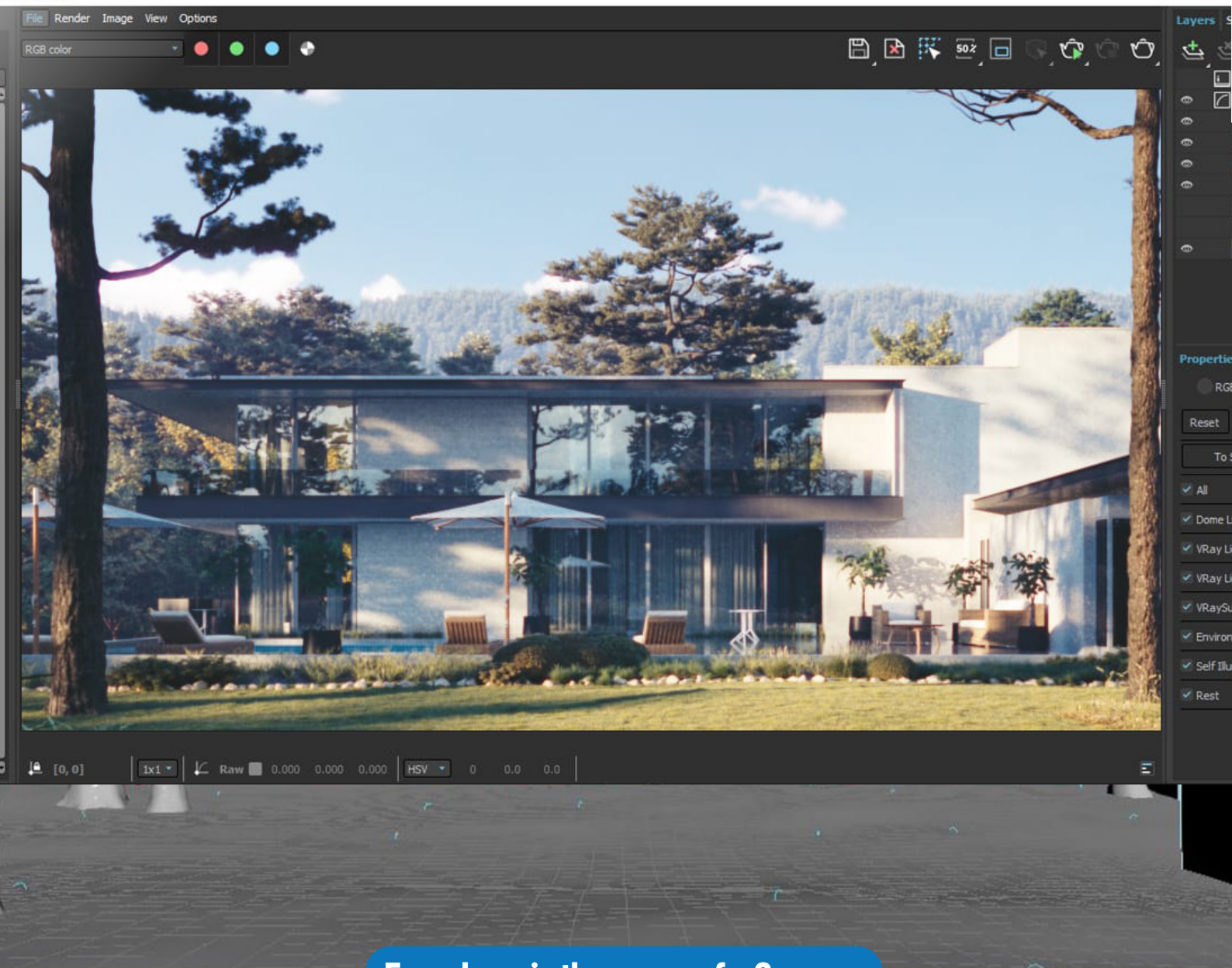

For whom is the course for?

This course is suitable for

- 3DSMAX Modelers
- Students who have the passion of becoming Interior Designer
- Professionals who wants to increase the 3D interior renderings

Pre-requisites

Basic understanding of computer is enough to learn this course.



About **VRAY**

Chaos® V-Ray® is a 3D rendering plugin available for all major 3D design and CAD programs. It works seamlessly with 3ds Max, Cinema 4D, Houdini, Maya, Nuke, Revit, Rhino, SketchUp, and Unreal.



Key features of Vray Plugin

- Realistic materials
- Ray traced lights & environments
- Vray physical camera
- High quality render outputs



Brief Contents



VRAY RENDERING

- V-Ray Interface
- V-Ray Elements
- Understanding V-Ray materials
- Learn settings for trial renders
- Understanding lights & material shaders
- V-Ray Camera
- V-Ray Sun & Dome light
- Setting enviroment by HDRI maps
- V-Ray IES & ambient lights
- Color mapping
- Learning Cosmos browser
- Camera depth of field & framebuffering
- Learning final render settings & exporting outputs

PROJECTS

- **Create an Enclosed scenes (Bedroom,Washroom or living room) with open to atmosphere light**
- **Create an Enclosed scenes (Bedroom,Washroom or living room) with not open to atmosphere light but only with artifical lights**
- **Create a scene of Both Lights mixed up (Atmo-sphere lights & Artifical lights)**





CONTACT US

ELEGANT  TRAINING

620, AB Center, Al Barsha 1, Beside Ibis Hotel, Sheikh Zayed Road, Near Insurance Market Metro Station, Dubai, UAE.

Phone : +971 4 399 7800

Mobile: +971 54 749 5664

Email: info@elegant-training.ae

Web: <https://www.elegant-training.ae/>

Approved & Permitted by KHDA

 **AUTODESK**
Authorized Training Center

 **idp** | **IELTS™**

 <https://www.facebook.com/ElegantTrainingAE/>

 <https://www.instagram.com/eleganttraining/>

 <https://www.linkedin.com/company/>

[WWW.ELEGANT-TRAINING.AE](https://www.elegant-training.ae)